

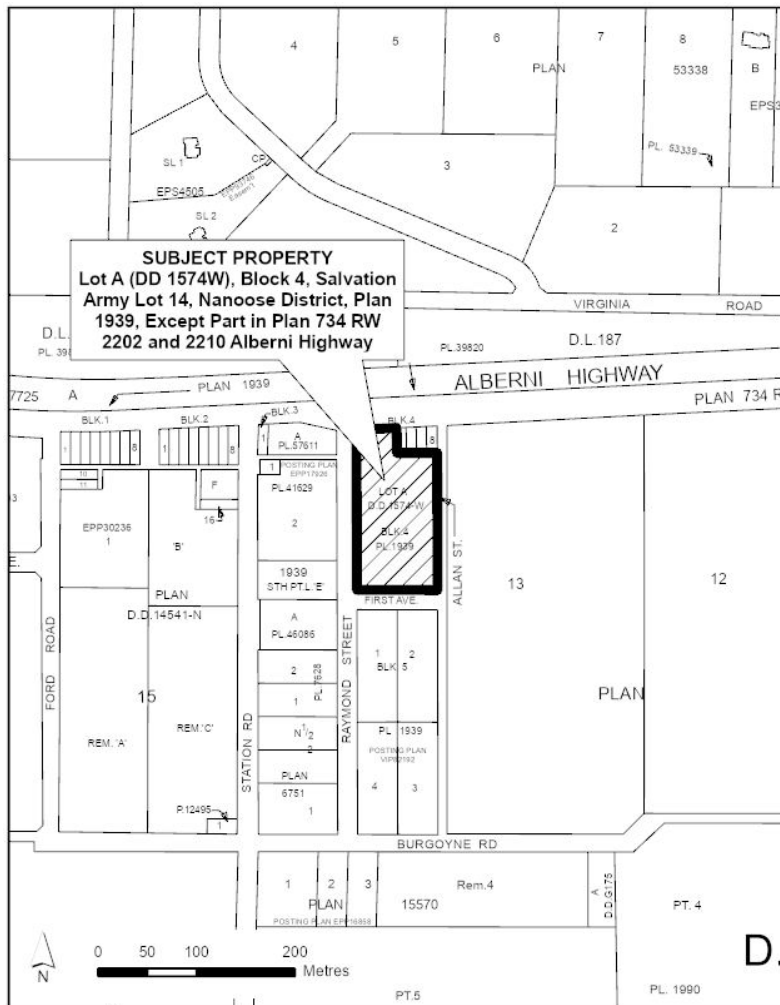

The Regional District of Nanaimo (RDN) is in receipt of a zoning amendment application for the property shown in the location map below.



For more information, please contact:

- ☎ 250-390-6510 or 1-877-607-4111
- ✉ planning@rdn.bc.ca
- 🌐 www.getinvolved.rdn.ca/pl2025-066

www.rdn.bc.ca

NOTICE OF ZONING AMENDMENT

APPLICATION NO. PL2025-066

2202 Alberni Highway
2210 Alberni Highway

PID 006-711-685

Electoral Area F

PURPOSE OF PROPOSED BYLAW

The applicant proposes to rezone the subject property from Village Residential 3 (R-3) to Commercial 2 (C-2) to permit the development of tourist accommodations, under the "Regional District of Nanaimo Zoning and Subdivision Bylaw No. 1285, 2002". The applicant intends to develop train themed tourist accommodations with replica or converted train cars (see proposed conceptual plan attached).

HAVE YOUR SAY AND ASK QUESTIONS

The public is invited to provide feedback and submit questions about the proposed zoning amendment application online at:

www.getinvolved.rdn.ca/pl2025-066

Comments and questions may also be submitted by email to planning@rdn.bc.ca or by mail or in person to the RDN Administration Office located at 6300 Hammond Bay Road, Nanaimo, B.C., V9T 6N2. Office hours are Monday to Friday, 8:30 a.m. to 4:30 p.m., excluding public holidays. Feedback must be received by **March 31, 2026**. Please do not include personal or confidential information about yourself or others in your written submission. Written submissions may be made publicly available through the RDN website and on public meeting agendas. As part of the application review process, the applicant, the Electoral Area Services Committee and the RDN Board will receive a summary of the feedback provided.

WHERE CAN I INSPECT THE APPLICATION?

Application information is available online at: www.getinvolved.rdn.ca/pl2025-066. If you are unable to access this application information online, please contact us by email or phone for a staff member to review it with you.

Get Involved RDN!

Attachment 1
Proposed Conceptual Plan

Conceptual Site Plan

