

The Regional District of Nanaimo (RDN) is in receipt of a zoning amendment application for the property shown in the location map below.

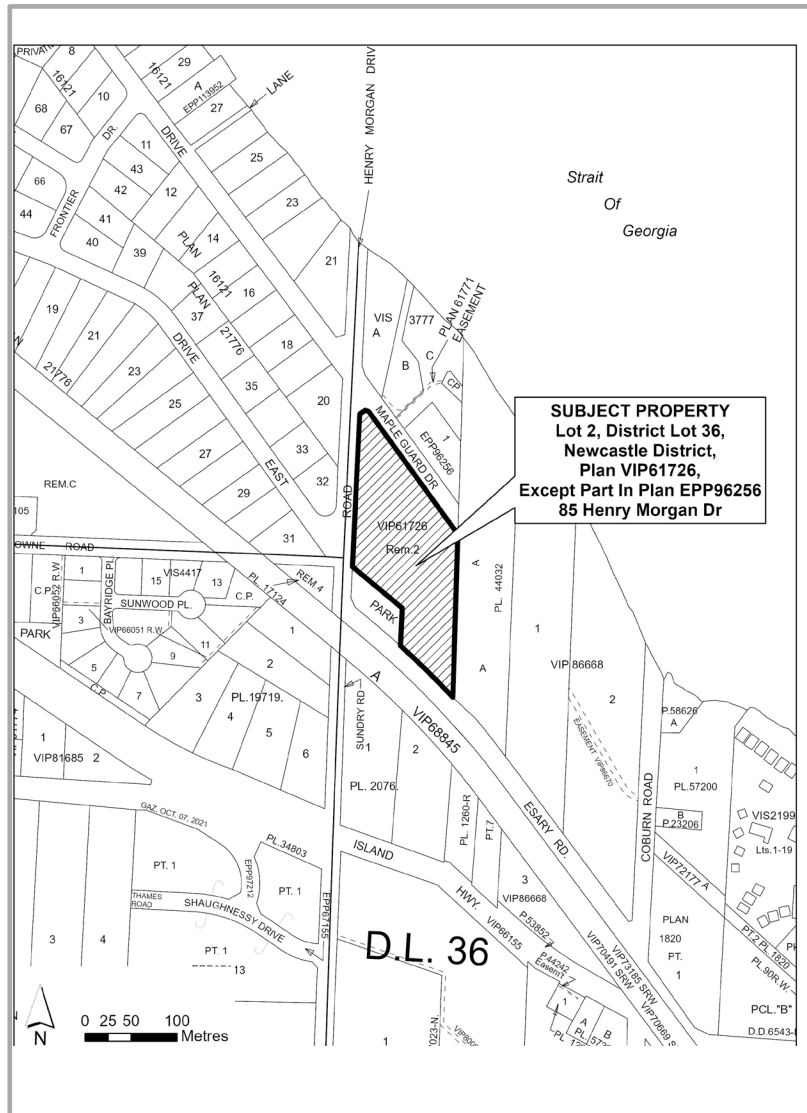

For more information, please contact:

- ☎ 250-390-6510 or 1-877-607-4111
- ✉ planning@rdn.bc.ca
- 🌐 www.getinvolved.rdn.ca/pl2023-101

NOTICE OF ZONING AMENDMENT

APPLICATION NO. PL2023-101

**85 Henry Morgan Drive
Electoral Area H**

PURPOSE OF PROPOSED BYLAW

The applicant proposes to rezone the subject property from Residential 2 (RS2) Zone to a Comprehensive Development Zone, under the "Regional District of Nanaimo Zoning Bylaw No. 2500, 2024", to allow the creation of a residential development consisting of up to eight parcels supporting one dwelling unit per parcel and one larger parcel supporting up to 19 dwelling units of limited size, generally as shown on Attachment 1.

HAVE YOUR SAY AND ASK QUESTIONS

The public is invited to provide feedback and submit questions about the proposed zoning amendment application online at:

www.getinvolved.rdn.ca/pl2023-101

Comments and questions may also be submitted by email to planning@rdn.bc.ca or by mail or in person to the RDN Administration Office located at 6300 Hammond Bay Road, Nanaimo, B.C., V9T 6N2. Office hours are Monday to Friday, 8:30 a.m. to 4:30 p.m., excluding public holidays. Feedback must be received by **October 23, 2025**. Please do not include personal or confidential information about yourself or others in your written submission. Written submissions may be made publicly available through the RDN website and on public meeting agendas. As part of the application review process, the applicant, the Electoral Area Services Committee and the RDN Board will receive a summary of the feedback provided.

WHERE CAN I INSPECT THE APPLICATION?

Application information is available online at: www.getinvolved.rdn.ca/pl2023-101. If you are unable to access this application information online, please contact us by email or phone for a staff member to review it with you.

Get Involved RDN!

Attachment 1 Conceptual Site Plan

