



REQUEST FOR TENDER No. 21-072

Errington Community Park Construction

ADDENDUM 2 ISSUED: September 15, 2021

This addendum shall be read in conjunction with and considered as an integral part of the Request for Tender. Revisions supersede the information contained in the original RFT document or previously issued Addendum. No consideration will be allowed for any extras due to any Vendor not being familiar with the contents of this Addendum. All other terms and conditions remain the same.

QUESTION & ANSWER

Question #1: Can you please provide a comprehensive list of all owner supplied items for this project?

Response #1: The RDN will be supplying all of the RecTec playground equipment in the base bid. Please see the attached document for this list.

End of Addendum 2

Parts List			
ITEM	SKU	COMPONENT NAME	QTY
1	NRO2010	WIZARDS DOUBLE TOWER FORTRESS	1
2	NRO822	WATERLILLIES BALANCE POST	4
3	NRO104	MULTI SPRINGER	1
4	NRO1026	MULTIDECK TOWER WITH BANISTER BARS	1
5	NRO606	THEATRE AND MUSIC COTTAGE	1
6	NRO524	OASIS SAND DIGGER	1
7	NRO912	DOUBLE COMBINATION SWING	1
8	M19101	TODDLER SPICA	1
9	NRO112	FOREST BUG SPINGER	1
10	NRO884	TURBO CHALLENGE	1



Delta Office
14-7228 Progress Way, Delta, BC
V4G1H2

Office: 1-800-661-8141
Fax: (604) 940-0162
www.rectectindustries.com

Scale: 1:150	Drawn by: M.G.
Date: Jun 21/21	Revision #: 0

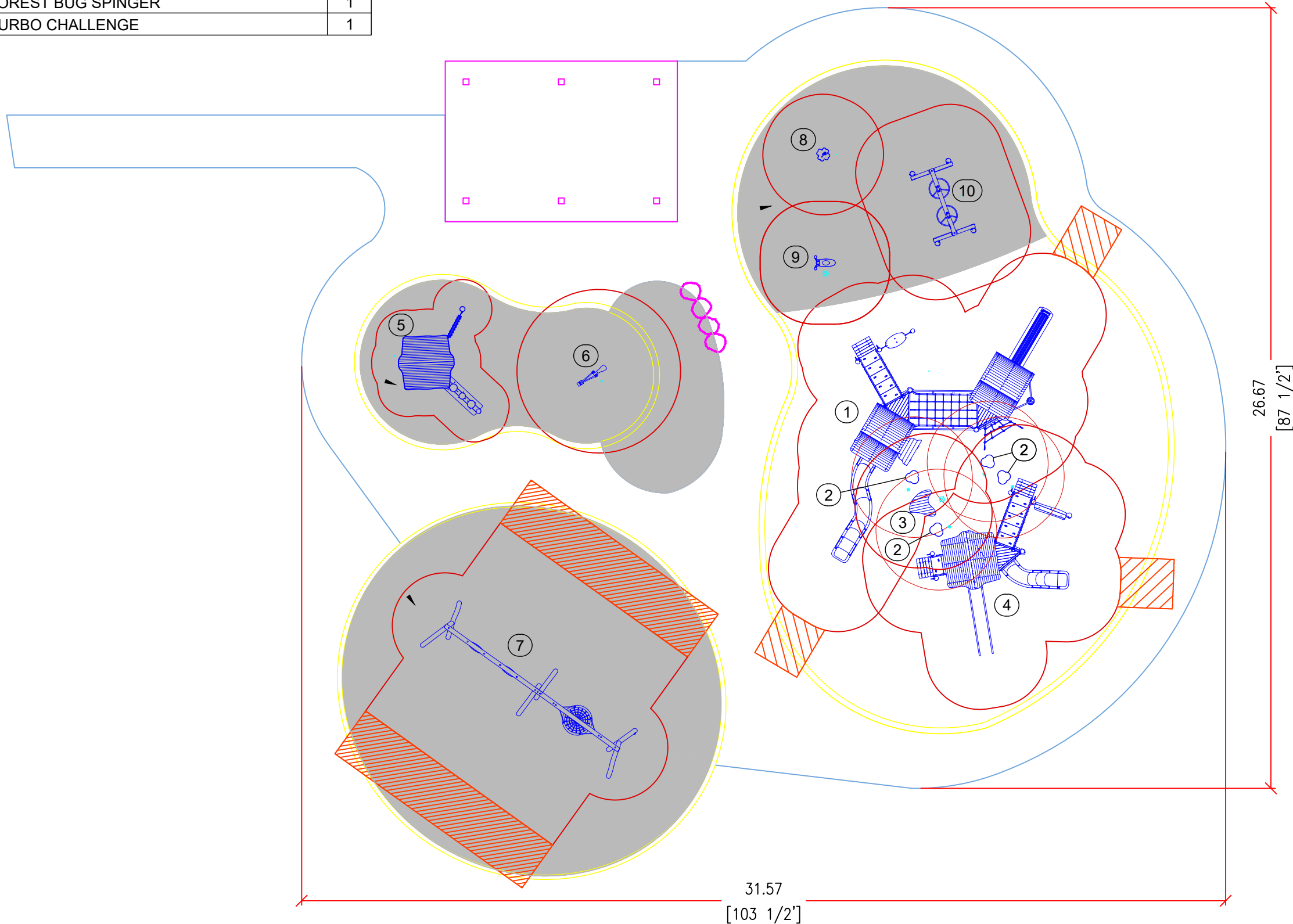

Errington Community Park - Concept 1 Errington, BC

Project #: 101662	Sales Rep: D.C.
Site Area: A/P CLIENT	Design Age: 2-12

**NOT FOR
CONSTRUCTION
PURPOSES**

Layout: 11 x 17	Sheet #: 1/1
--------------------	-----------------

**NOTE: EQUIPMENT
CONFORMS TO
CAN/CSA-Z614-20
STANDARD -
CHILDREN'S PLAYSPACES
AND EQUIPMENT**

REV	DESCRIPTION	REV BY	REV DATE